

AIRPORT DATA			LEGEND		
		EXISTING	FUTURE		
AIRPORT ELEVATION (MSL)		159'	158'	FACILITIES	
DATUM FOR ALL ITEMS		NAD 83/NAVD 29	SAME	BUILDINGS	
AIRPORT REFERENCE POINT		LAT. N 45° 11' 40.19"		RUNWAY	
COORDINATES (ARP)		LONG. W 123° 08' 9.91"		BUILDING RESTRICTION LINE (BRL)	BRL
AIRPORT MAGNETIC VARIATION		17° 39' E	SAME	AIRCRAFT PARKING LINE (APL)	APL
MEAN MAXIMUM TEMPERATURE		82.7 (F)	SAME	AIRPORT PROPERTY LINE	
NPIAS ROLE		GA	GA	RUNWAY SAFETY AREA (RSA)	
AIRPORT REFERENCE CODE (ARC)	SEE RUNWAY DATA BELOW		SAME	OBJECT FREE AREA (OFA)	
AIRPORT CODE	MMV		SAME	OBSTACLE FREE ZONE (OFZ)	
LAND OWNED IN FEE (ACRES)				RUNWAY VISIBILITY ZONE (RVZ)	
DECLARED DISTANCES				GROUND CONTOURS	640
		RUNWAY 4	RUNWAY 22	AIRPORT REFERENCE POINT (ARP)	
		EXISTING	FUTURE	EXISTING	FUTURE
TAKEOFF RUN AVAILABLE (TORA)	5420'	SAME	5420'	SAME	
TAKEOFF DISTANCE AVAILABLE (TODA)	5420'	SAME	5420'	SAME	
ACCELERATE-STOP DISTANCE (ASDA)	5420'	SAME	5420'	SAME	
LANDING DISTANCE AVAILABLE (LDA)	5420'	SAME	5420'	SAME	
		RUNWAY 17	RUNWAY 35	RUNWAY LIGHTS	NONE
		EXISTING	FUTURE	EXISTING	FUTURE
TAKEOFF RUN AVAILABLE (TORA)	4340'	SAME	4340'	SAME	
TAKEOFF DISTANCE AVAILABLE (TODA)	4340'	SAME	4340'	SAME	
ACCELERATE-STOP DISTANCE (ASDA)	4340'	SAME	4340'	SAME	
LANDING DISTANCE AVAILABLE (LDA)	4340'	SAME	4340'	SAME	
				VISUAL GUIDANCE INDICATORS	PAPI
				SEGMENTED CIRCLE	
				WIND INDICATOR	
				AVIGATION EASEMENT	
				FENCE	
				RUNWAY PROTECTION ZONE (RPZ)	
				BEACON	
				THRESHOLD LIGHTS	
				REIL	

All weather wind rose based on 16,213 observations on McMinnville (Station No. 94259) from 1/47 to 2/51. Calms = 43.3%

	VFR		IFR		ALL	
	12 mph	15 mph	12 mph	15 mph	12 mph	15 mph
RUNWAY 4-22	86.74	89.43	91.54	93.59	86.75	90.21
RUNWAY 17-35	92.30	94.86	97.48	98.05	92.38	95.17
COMBINED	97.85	98.43	98.26	98.84	97.66	98.45

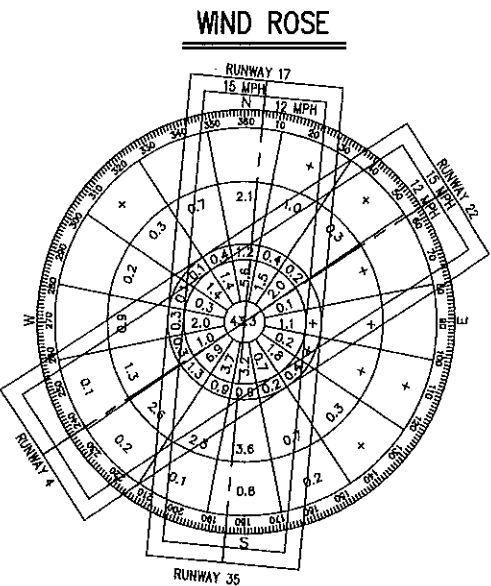

SOURCE: NOAA DATA; 1980 McMinnville Airport Master Plan

RUNWAY DATA 4/22		
		EXISTING
LENGTH AND WIDTH		5420' X 150'
AIRPORT REFERENCE CODE (ARC)		D-II
PERCENT EFFECTIVE GRADIENT		0.02%
PERCENT WIND COVERAGE (15 MPH)		90.21%
PAVEMENT TYPE		ASPHALT
PAVEMENT STRENGTH (000)		S-40; D-50; DT-80
APPROACH TYPE		PRECISION INSTRUMENT
FAR PART 77 DESIGNATION		LARGER THAN UTILITY (PIR)
APPROACH SLOPE REQ'D/CLEAR	4	34:1
	22	50:1/40:1
RUNWAY LIGHTING		HIRL, MALSR (RWY 22)
RUNWAY MARKING		PRECISION (RWY 22); NP (RWY 4)
RUNWAY SAFETY AREA		7420' X 500'
OBJECT FREE AREA		7420' X 800'
OBSTACLE FREE ZONE		5820' X 400'
CRITICAL AIRCRAFT		GULFSTREAM IV
NAVIGATIONAL AIDS		ILS, NDB, GPS
APPROACH AND LANDING AIDS	4	REIL, PAPI
	22	MALSR, PAPI
RUNWAY END COORDINATES	4	N 45° 11' 30.35" W 123° 08' 53.46"
	22	N 45° 11' 59.34" W 123° 07' 49.86"
TAXIWAY LIGHTING		MITL

RUNWAY DATA 17/35		
		EXISTING
LENGTH AND WIDTH		4340' X 75'
AIRPORT REFERENCE CODE (ARC)		B-II
PERCENT EFFECTIVE GRADIENT		0.04%
PERCENT WIND COVERAGE (15 MPH)		95.17% ALL WEATHER
PAVEMENT TYPE		ASPHALT
PAVEMENT STRENGTH (000)		S-30
APPROACH TYPE		VISUAL
FAR PART 77 DESIGNATION		LARGER THAN UTILITY - VISUAL
APPROACH SLOPE REQ'D/CLEAR	17	20:1/20:1
	35	20:1/20:1
RUNWAY LIGHTING		NONE
RUNWAY MARKING		BASIC
RUNWAY SAFETY AREA		4940' X 150'
OBJECT FREE AREA		4940' X 500'
OBSTACLE FREE ZONE		4740' X 400'
CRITICAL AIRCRAFT		CITATION EXCEL (C560XL)
NAVIGATIONAL AIDS		NDB, GPS
APPROACH AND LANDING AIDS	17	NONE
	35	NONE
RUNWAY END COORDINATES	17	N 45° 11' 56.12" W 123° 07' 52.00"
	35	N 45° 11' 13.49" W 123° 07' 58.22"
TAXIWAY LIGHTING		NONE

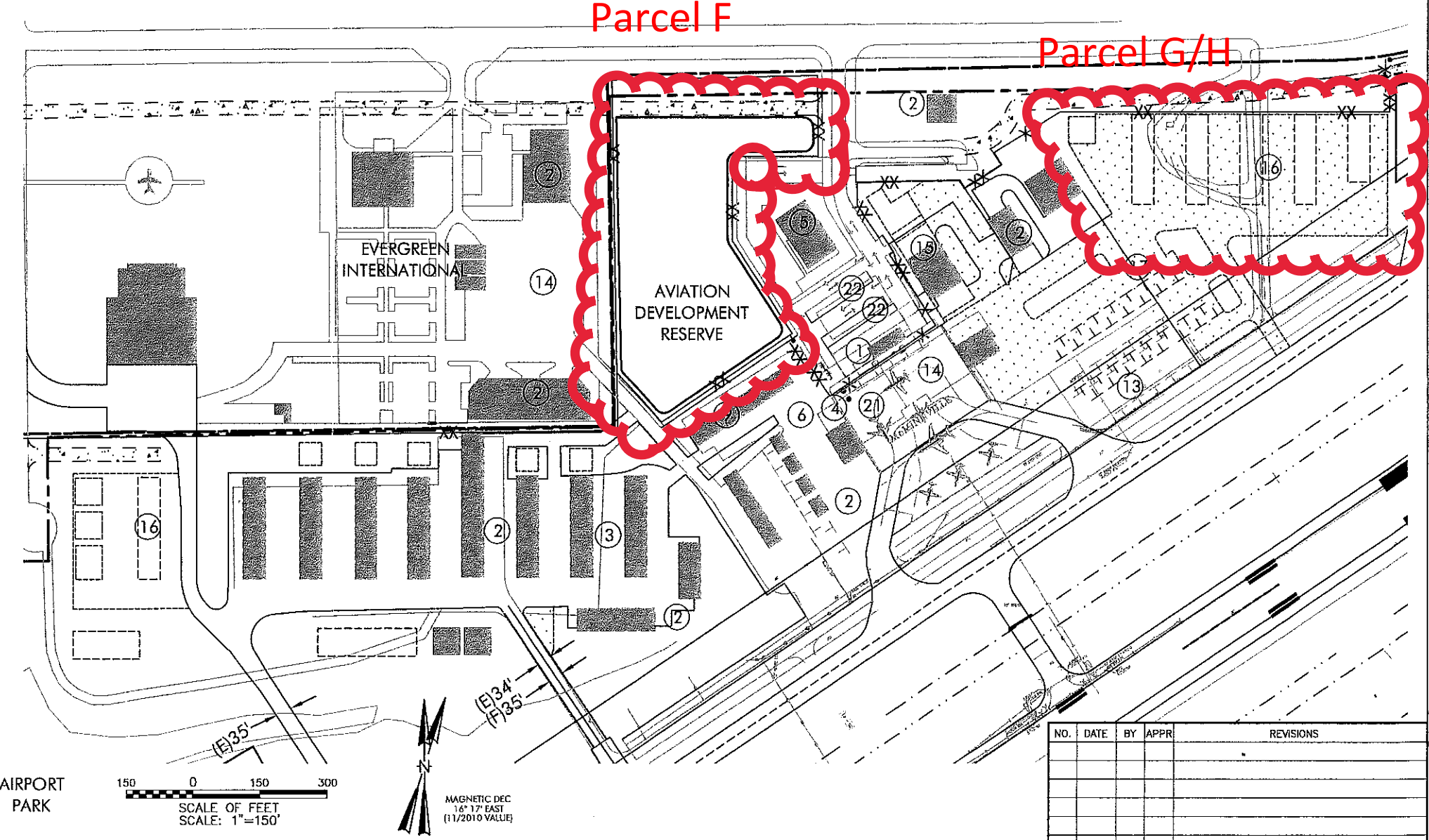

\* SEE ALP (SHEET 3) FOR LEGEND OF BUILDING AND FACILITIES

"THE PREPARATION OF THIS DOCUMENT MAY HAVE BEEN SUPPORTED, IN PART, THROUGH THE AIRPORT IMPROVEMENT PROGRAM FINANCIAL ASSISTANCE FROM THE FEDERAL AVIATION ADMINISTRATION AS PROVIDED UNDER TITLE 49, UNITED STATES CODE, SECTION 47104. THE CONTENTS DO NOT NECESSARILY REFLECT THE OFFICIAL VIEWS OR POLICY OF THE FAA. ACCEPTANCE OF THESE DOCUMENTS BY THE FAA DOES NOT IN ANY WAY CONSTITUTE A COMMITMENT ON THE PART OF THE UNITED STATES TO PARTICIPATE IN ANY DEVELOPMENT DEPICTED HEREIN NOR DOES IT INDICATE THAT THE PROPOSED DEVELOPMENT IS ENVIRONMENTALLY ACCEPTABLE IN ACCORDANCE WITH APPROPRIATE PUBLIC LAWS."

VERIFY SCALES  
BAR IS ONE INCH ON ORIGINAL DRAWING.  
0" = 1" IF NOT ONE INCH ON THIS SHEET, ADJUST SCALES ACCORDINGLY.

FEDERAL AVIATION  
ADMINISTRATION APPROVAL

APPROVAL DATE: \_\_\_\_\_  
SIGNATURE

CITY OF MCMINNVILLE/  
APPROVAL

APPROVAL DATE: \_\_\_\_\_  
SIGNATURE

CENTURY WEST  
ENGINEERING CORPORATION  
9630 S.W. Redwood Lane, Suite 300  
Portland, Oregon 97224  
503-410-2130 ph. 503-630-2710 fax  
www.centurywest.com

IN ASSOCIATION WITH:

ARON FAEGRE and ASSOCIATES  
Portland, Oregon

DESIGNED BY:  
DM  
DATE: DECEMBER 2004

DRAWN BY:  
SLK

CHECKED BY:  
P.Y.  
PROJECT NO:  
40480002.01.4001

SCALE:  
AS SHOWN

MCMINNVILLE MUNICIPAL AIRPORT  
DATA SHEET AND  
AIRPORT TERMINAL AREA

DRAWING NO.

SHEET NO.

2 OF 8